



CROSSROADS
THE TURNING POINT

LET'S BEGIN A JOURNEY...

PATHWAY TO DIGNITY PROJECT

Creating a space where ALL are welcome

For more than 26 years, Crossroads has opened its doors to neighbors in crisis, welcoming them on a journey to stability.

We invite you to join the journey!

WHAT

The **Pathway to Dignity Project** is a structural enhancement we've desired for years to better serve our guests as well as to functionally make operations flow in a more seamless and productive way.

WHY

DIGNITY is a core value of Crossroads which we seek to practice in every aspect of our work. An area we sought to improve was in our initial engagement with our guests. Guests arrive and have to wait outside, in the elements, feeling judgment by those passing by as well as internal judgement for needing support. We've taken steps to combat these realities, but nothing has fully remedied the situation. This project will help us fully express **DIGNITY** to our guests by helping them to be **SEEN, HEARD** and **SUPPORTED**.

Studies have shown how ones environment can drastically impact their overall health. The National Library of Medicine has numerous articles showing how environmental design can positively or negatively impact ones outcome. This translates across the board for our guests who are in unique situations, often riddled with various crises, compounded with housing instability. By investing in their first touch point with us, we're expanding the possibility for our guests journey to begin or continue in such a manner that stability is more likely.

SEEN

Dignity calls us to see the value and potential of each person we encounter. Too often those experiencing homelessness are overlooked because of ignorance and fear, or they are seen in a negative light based upon false stereotypes that are universally applied. The **Pathway to Dignity Project** creates a physical space where every individual can be seen as part of a productive and caring community.

HEARD

With thousands of our neighbors experiencing homelessness or housing instability in Atlanta, it is easy for an individual voice to go unnoticed as they fight to survive and navigate an often complex and overwhelming social service landscape. Dignity calls us to listen to the unique stories of each guest in order to walk with them in the most effective way possible. The **Pathway to Dignity Project** allows us the physical space we need for every voice to be heard in a safe and welcoming environment.

SUPPORTED

Homelessness is a lonely, isolated and traumatic reality. For most, the road to stability in life is a long and often frustrating journey. Dignity calls us to walk with our guests in whatever way is needed. At Crossroads, we share consistent and empowering support allowing our guests and entire community to realize the power that already exists within them. The **Pathway to Dignity Project** will allow us to spend more one-on-one time getting to know our guests, making the support we provide as effective and permanent as possible.

CHECK IT OUT!

Please see renderings provided by Koons Environmental Design for the **PATHWAY TO DIGNITY PROJECT!**

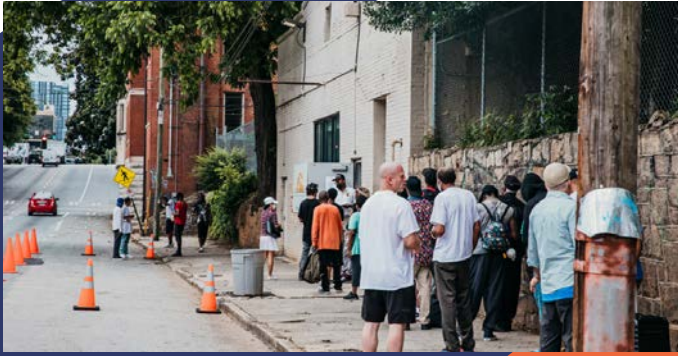

Above: Current View



Above: Current View



Above: Projected View



Above: Overhead View



Above: Side View

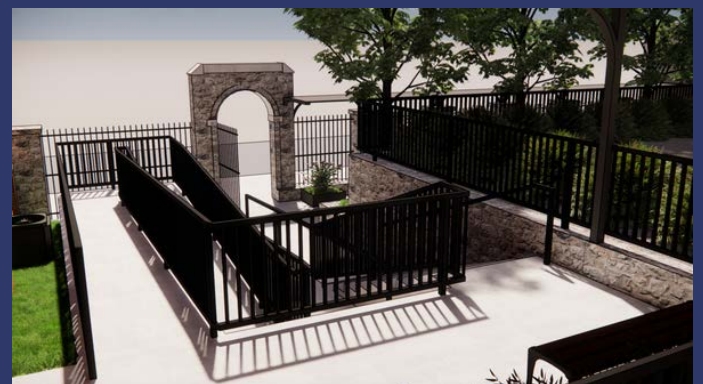

Above: ADA Entrance View

Bridging the gap towards **Stability**

Help Complete our Pathway to **DIGNITY!**

Scan
For More
Information



Thanks to the generosity of numerous foundations and individuals, we have secured **\$1,000,000!**

TOTAL PROJECT COST - \$1,300,000

SPONSOR LEVELS

\$500K

Dignity Sponsor - Project Name Recognition

- Social media outlet recognition

\$250K

Equity Sponsor - Entry Name Recognition

- Social media outlet recognition

\$100-200K

Compassion Sponsor - Site Name Recognition

- Social media outlet recognition

\$25-50K

Community Sponsor - Plaque Recognition

- Social media outlet recognition

For Additional Information:

Contact Tony Johns - Crossroads Executive Director

tony@crossroadsatlanta.org, (404)873-7652

Environmental and aesthetic enhancements to a space that serves individuals experiencing crisis can highly impact the effectiveness and significance of the care given. A well-crafted space can provide a sense of grounding and regulation for those in crisis and allow them to relax, experience a sense of safety, and be more open to the care they are receiving. Thus, those providing the care will be able to assist individuals more immediately and effectively while the individuals receiving the care can be more readily responsive and collaborative.

Kaleigh Newby, MA - Executive Director Richmond Trauma Center